



Uki City

Toyono Elementary and Junior High School

くまもと
アートポリス
KUMAMOTO
ARTPOLIS

Uki City Toyono Elementary and Junior High School

● Building Plan Outline

The Toyono Elementary and Junior High School is an integrated elementary and junior high school combined into a single facility, making the most of the neighboring junior high school complex during reconstruction of the elementary school. Continuous education is thought to be effective in alleviating the "chuichi gap" (difficulty in the transition to junior high school) which sometimes leads to non-attendance at school. Special classrooms and the gymnasium are shared between the schools for effective use. The existing junior high school has been reinforced against earthquakes and also partially modified. The design was made through the joint venture of Koizumi Atelier and SDA Architects and Associates.

The school building and the gymnasium exist in two parallel rows in the junior high school complex. The new school building was planned to have a shape that would fill up the surplus space. As a result, the new building has a flat shape surrounded by a soft curved line enveloping the outer shape of the existing structure. A single roof gently undulates above it all. The undulations have been derived from the ceiling height in accordance with the function of the rooms underneath. The roof spans in one direction over beams of laminated wood, and appears to be extending in different directions depending on where it is viewed inside the school building. The single roof appears expansive and gives the students the feeling of being under the same roof, literally, and helps promote a sense of togetherness among the children and students.

This shape, in which the space is enclosed by a soft curve, is a futuristic concept. When the junior high school is reconstructed in the future, the soft curved shape reminds us where the original buildings were.

This building physically connects the old and new buildings, and also connects the feelings of the students of the elementary school and junior high school. It is a "connecting" school building that plays the role of connecting memories with the future.

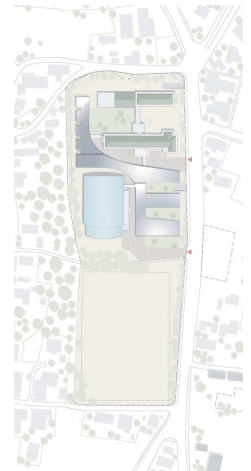

● Architect Profile



Masao Koizumi

1986 Established COELACANTH while graduating from the University of Tokyo Graduate School
 1988 Completed Master's Course from the above-mentioned University
 2001 ~ Assistant Professor in the Tokyo Metropolitan University Graduate School
 2005 Established Koizumi Atelier
 2010 ~ Professor and Doctor in Architecture at the Metropolitan University
 Tokyo Graduate School Environmental Science Postgraduate Course

● Main Works

Ashita no ie (future homes), Toda City Ashihara Elementary School, Chiba-shi Mihama Cultural Hall and Health and Welfare Center, Zou-no-hana Park and Terrace, LCCM Demonstration House

● Record of Awards

2004 2nd Sustainable Housing Award by the Ministry of Land, Infrastructure and Transport, Work selected by the Architectural Institute of Japan
 2005 Incentive Award by the Japan Federation of Architects & Building Engineers Association, 2008
 2009 13th Public Architecture Excellence Award, 55th Kanagawa Construction Contest Excellence Award, 22th AACA Excellence Award

SDA Architects and Associates

● Main Works

Obiyama Prefectural Housing Project No. 2, Kumamoto Nissan Motor Corporation PARAISSO, Amakusa Technical High School Practice Building and Gymnasium, Misato Center General Gymnasium, Takamori Town Takamori Junior High School, Taragi Town Taragi Elementary School, etc.

● Record of Awards

1987 Recommendation by the Ministry of Construction in the National Construction Week
 2002, 2003, 2005 Kumamoto Federation of Wood Industry Associations Award
 2012 Kumamoto Federation of Forestry Cooperatives

● Construction Data

Name	Uki City Toyono Elementary and Junior High School
Address	3536 Itoishi, Toyono-machi, Uki-shi, Kumamoto
Main usage	Elementary and Junior High School
Operating body	Uki City Board of Education
Designed by	Masao Koizumi + SDA Architects and Associates
Constructed by	Building/ (First stage construction work): Masunagagumi (Second stage construction work): Toda/Takematsu JV Electricity/Kyudenko Corporation Air-conditioning & Hygiene/Kyudenko Corporation External Construction /Okumura Construction
Site area	2,7408.12 m ²
Construction area	4,204.76 m ²
Total floor area	5,169.82 m ² (including partially modified area)
No. of floors	First floor above the ground (reconstructed building), second floor above the ground (existing modified building)
Structure	Wooden (roof), Reinforced concrete with some steel frame (building)
Exterior finish	Roof: Stainless resistance seam welding method of construction Back-eaves: Fiber mixture calcium silicate board Outer wall: Concrete casting release repair + Saturated colored water repellent Make-up mold concrete casting release + Saturated clear water repellent Ceramics system siding + Saturated colored water repellent Brick tiles
Duration of construction	January 2012 to April 2012 (First stage construction work), April 2012 to March 2013 (Second stage construction work)
Total construction cost	57,000,000 yen (First stage), 750,000,000 yen (Second stage)

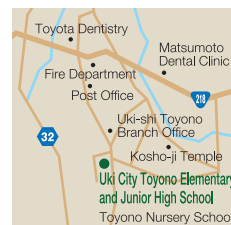

Kumamoto Artpolis Office

Kumamoto Prefectural Government Department of Civil Engineering Architecture and Housing Bureau Architecture Division

6-18-1 Suizenji, Chuo-ku, Kumamoto-shi, 862-8570
 Tel : 096 333 2537